

Drain: MASTHEAD DRAIN Drain #: 203  
 Improvement/Arm: MASTHEAD - SECTION 7  
 Operator: JDH Date: 1-27-04  
 Drain Classification: Urban/Rural Year Installed: 1985

### GIS Drain Input Checklist

- Pull Source Documents for Scanning JDH 1-29
- Digitize & Attribute Tile Drains N/A
- Digitize & Attribute Storm Drains JDH 2-2
- Digitize & Attribute SSD N/A
- Digitize & Attribute Open Ditch JDH 2-2
- Stamp Plans JDH 2-2
- Sum drain lengths & Validate JDH 2-2
- Enter Improvements into Posse JDH 2-2
- Enter Drain Age into Posse July 3-2
- Sum drain length for Watershed in Posse July 3-2
- Check Database entries for errors JDH 2-2

**Gasb 34 Footages for Historical Cost  
Drain Length Log**

Drain-Improvement: MASTHEAD DRAIN - MASTHEAD - SECTION 7

Drain Type:	Size:	Length <i>(SURVEYORS REPORT)</i>	Length (DB Query)	Length Reconcile	If Applicable	
					Price:	Cost:
	12"	785'	785'			
	36"	135'	135'			
OPEN DITCH		820'	820'			
OTHER		120'	120'			

Sum:      1860'      1860'      Ø

Final Report: \_\_\_\_\_

Comments:

\_\_\_\_\_

\_\_\_\_\_

\_\_\_\_\_

\_\_\_\_\_

\_\_\_\_\_



SURVEYOR'S OFFICE

# Hamilton County

*Kenton C. Ward, Surveyor*

*Phone (317) 776-8495*

*Fax (317) 776-9628*

*Suite 146*

*One Hamilton County Square*

*Noblesville, Indiana 46060-2230*

March 9, 1998

To: Hamilton County Drainage Board

Re: Masthead Drain, Sections 7, 8 & 9 Arms

Attached is a petition, drain map and drainage shed map for Sections 7, 8 & 9 Arms to the Masthead Drain. The petition was filed in April 1992 by the Hamilton County Commissioners.

The petition is to place the drainage facilities in Sections 7, 8 & 9 of Masthead on a maintenance program. The drainage facilities in Sections 10 to 16 of Masthead are currently on a maintenance program. The facilities proposed to become part of the regulated drain are listed below by section.

**Section 7**

- ✓ A) 135' - 36" pipe under Fall Creek Road between lots 47 and 54 of Geist Woods and lot 215 of Masthead Section 7.
- ✓ B) 140' - 12" CMP in right-of-way Fall Creek Road in front of lot 215 and outletting in ravine which crosses lot 215 and outlets in open ditch between lots 215 and 216.
- ✓ C) 60' open ditch (ravine described above) across front of lot 215. 580' open ditch from outlet of 36" pipe under Fall Creek Road to Geist Reservoir running between lots 215 and 216 and through Block RR.
- ✓ D) 20' - <sup>12"</sup> ~~12"~~ CMP & 253' - 12" CMP in Block R and Block RR.
- ✓ E) 372' CMP in Block Q, between lots 217 and 218 and outletting in Block RR.
- SITE* ✓ F) 120' <sup>12"</sup> pipe under Fall Creek Road between the Common Area in Geist Woods and lot 221 in Masthead Section 7.
- ✓ G) 180' open ditch from above described pipe under Fall Creek Road and Geist Reservoir between lots 221 of Section 7 and lots 233 and 234 in Section 8 of Masthead.

The total length of the proposed drain for Section 7 is **1860 feet.** ✓

**Section 8**

- ✓ A) 216' - 12" CMP running from Farragut Circle to the reservoir through Block V and between lots 254 and 255.
- ✓ B) 462' - 12" CMP running from Block S to the ravine at the rear of lots 258-259, pipe section runs through Block S and between lots 258-259.
- ✓ C) 96' - 12" CMP running from lot 227 to lots 258-257 under DeCatur Avenue.
- ? - D) 340' - open ditch between above described pipe under DeCatur Avenue to the reservoir along rear of lots 255, 256, 257, 258, 259 and 260.
- ✓ E) 185' - 12" CMP running between Block U and Geist Reservoir between lots 242 and 243.
- ✓ F) 150' - 12" CMP running between DeCatur Avenue and open ditch on North and West side of lot 236.
- ✓ G) 388' - 12" CMP running from Blocks T and U to the reservoir. This pipe section runs through Block T between lots 235 and 238 and through Block U between lots 237 and 238. This includes the 80 feet of 18" CMP which was placed between lots 235 and 238 in 1988.

- ✓ H) 240' - open ditch running from the above described line which drains DeCatur Avenue and to an inlet in the junction of the above described lines from Blocks T and U. Ditch runs across rear of lots 236 and 237. This area has now been filled. Upon site inspection, plastic pipe was used to extend the drain to and through the headwall into the reservoir. This pipe is accepted into the system.
- ✓ I) Open ditch along west sides of lots 233 and 234 has been described with Section 7.
- ✓ J) The 36" pipe running from Fall Creek Road to the reservoir along the east side of lot 263 is part of the Windjammer Drain. This was done per my report dated November 21, 1989 which was approved at the hearing on February 20, 1990.

The total length for this section is **2077 feet**.

**Section 9**

- A) The 36" CMP along the west side of lot 264 running between Fall Creek Road and the reservoir is part of the Windjammer Drain. Also, the section of pipe between Fall Creek Road and the reservoir between lots 272, 273, 274 and 275 is part of the Windjammer Drain per my report dated January 3, 1989. Both of these pipe sections will remain as part of the Windjammer Drain.
- ✓ B) 180' - open drain, 56' - 12" CMP between Spruance Ct. and the reservoir along the north side of lot 291.
- ✓ C) 85' - 12" CMP between Block X and the reservoir running through Block X and lot 291.
- ✓ D) 100' - open ditch, 125' - 12" CMP between Nautilus Circle and the extended 36" pipe described in "A" above, running across lot 274.
- ✓ E) 100' - open ditch, 186' - 12" CMP between Block W and Nautilus Circle running to the reservoir across the north side of lot 268 and between lots 268 and 269.
- ✓ F) 290' - open ditch, 148' - 12" CMP running from Halsey Drive to the reservoir between lots 281, 282, 283 and 284.
- ✓ G) 70' - 15" pipe under Fall Creek Road.
- ✓ H) 90' - 15" RCP, 70' - open ditch running from "G" above to the open ditch described in "F" above running across lot 282. The pipe extension was approved and constructed in 1990 by Michael Hale, designed by P.I. Cripe, Inc., job number 89-353-00000.
- ✓ I) 88' - 12" CMP, 50' - open ditch, running from Halsey Drive to the inlet placed on the extended line described in "H" above. This runs in the right-of-way of Fall Creek Road.

The total length for this section is **1638 feet**. ✓

The total length for all 3 sections is **5,575 feet**.

I recommend to the Board that the drainage easements shown on the recorded plats for Sections 7, 8 and 9 be accepted as the easements for the proposed extension of the regulated drain. These are recorded as instrument numbers 37335, 37336 and 847368 respectively.

The current maintenance assessment for the Masthead Drain is \$2.00 per acre with a \$20.00 minimum. The current balance in the fund is \$22,274.45. I do not recommend an increase in assessment and recommend that the proposed extension be assessed at the current rate for the Masthead Drain.

Reconstruction costs shall be set at \$0.00. Upon review of the proposal, I recommend that damages for all tracts be set at \$0.00.

I request that a hearing be set for this item for April 1998.

KCW/jh

\_\_\_\_\_  
Kenton C. Ward,  
Hamilton County Surveyor

IN THE MATTER OF THE MASTHEAD DRAIN  
HAMILTON COUNTY DRAINAGE BOARD

Comes now the Board of Commissioners of Hamilton County, who petition the Hamilton County Drainage Board as follows:

1. They are the duly elected Board of Commissioners of Hamilton County, Indiana.
2. That in that capacity they are responsible for the drainage of public highways.
3. That they now desire that a regulated drain be reconstructed in Fall Creek Township which involves Fall Creek Road and various areas surrounding the road in the drainage shed.
4. The names and address of each owner affected by the proposed public drainage are attached hereto, made a part hereof, and marked Exhibit "A", which area of land involved in the proposed drainage area is located in section 9, township 17 north, range 5 east, Hamilton County, Indiana, being Sections 7, 8 & 9 of Masthead.
5. No other public lands or owners are located in the area which would affect improvement.
6. That the general route of the proposed drain is shown in the attached development plans for Masthead Sections 7, 8 & 9 which are marked Exhibit "B" and made a part herof.
7. That in the opinion of the Petitioner, the costs, damages, and expenses of the proposed improvement will be less than the benefits which will result to the owners of the land to be benefited thereby.
8. That in the opinion of Petitioner, the proposed improvement will benefit a public highway in Hamilton County, Indiana.
9. That the name of the attorney representing Petitioner in the drainage petition is Michael Howard, 694 Logan St., P.O. Box 410, Noblesville, Indiana.
10. That Petitioners shall pay the cost of notice and all legal costs if the Petition is dismissed.
11. Petitioner shall post a bond, if required, to pay the cost of notice and all legal costs in the case the improvement is not established.

Board of Commissioners of  
Hamilton County, Indiana

BY: Steven A. Holt  
Steven A. Holt

BY: \_\_\_\_\_  
Steven C. Dillinger

BY: William R. Karn  
William Karns

Attest:  
Polly Pearce  
Polly Pearce, Auditor of Hamilton County

STATE OF INDIANA )  
                          ) SS:  
COUNTY OF HAMILTON)

Subscribed and sworn to before me, a Notary Public this 20<sup>TH</sup> day of APRIL, 1992.

Rebecca S. Ulise  
Notary Public of Hamilton County

My Commission Expires:  
JUNE 1994

**Hamilton County Drainage Board  
1 Hamilton Square  
Noblesville, IN 46060**

**Reference : proposal for regulated drains in Masthead sections 7, 8 & 9.**

**Reason for regulations and annual maintenance / assessment :  
"water problems".**

We, the residents of Masthead, section ~~9~~<sup>8</sup>, object with the petition / proposal that the drains be regulated and assessed with an annual fee to the property owner. We have no knowledge of water related problems effecting our property or the roads in Masthead section ~~9~~<sup>8</sup>.

1.21%

**Name : Address: Lot # :**

✓	Don	✓	9693 Decatur Dr. (N. Hwy)	247	✓
			9693 Decatur Dr	247	
			9698 Decatur Dr. Hall, John	229	✓
			9687 Decatur Dr	246	✓
			9687 Decatur Dr	246	✓
			9704 Decatur Dr	228	✓
			9705 Decatur Dr	248	✓
			9705 Decatur Dr	248	✓
			9668 FARRAGUT CIRCLE	Lot 249	✓
			9698 Decatur Dr	229	✓
			9674 Decatur W (Crossland)	232	✓
			9686 Decatur Dr	236	✓
			9686 Decatur Dr	236	✓

**F I L E D**  
APR 22 1998

HAMILTON COUNTY DRAINAGE BOARD

SECRETARY



FINDINGS AND ORDER  
CONCERNING THE MAINTENANCE OF THE  
Masthead DRAIN

On this 27th day of April 1998, the Hamilton County Drainage Board has held a hearing on the Maintenance Report and Schedule of Assessments of the Masthead

Evidence has been heard. Objections were presented and considered. The Board then adopted the original/amended Schedule of Assessments. The Board now finds that the annual maintenance assessments will be less than the benefits to the landowners and issues this order declaring that this Maintenance Fund be established.

HAMILTON COUNTY DRAINAGE BOARD

Sharon R. Clark  
President

James A. Clark  
Member

Steven C. Dellinger  
Member

ATTEST: Janice Ellen Adams  
Administrative Secretary  
Revised 12/95



BEFORE THE HAMILTON COUNTY DRAINAGE BOARD  
IN THE MATTER OF THE Masthead Drain

NOTICE

TO WHOM IT MAY CONCERN AND Henderson, Alan L.; Baker,  
Mulvin & Barbara S.; \_\_\_\_\_  
\_\_\_\_\_  
\_\_\_\_\_

Notice is hereby given of the Hearing of the Hamilton County Drainage Board on the Masthead Drain, on April 27, 1998, at 9:15 A.M. in the Commissioner's Court, Hamilton County Judicial Center, One Hamilton County Square Noblesville, Indiana and which the Maintenance Report of the Board have been filed and are available for public inspection in the Office of the Hamilton County Surveyor.

Hamilton County Drainage Board

ATTEST

  
Administrative Secretary

ONE TIME ONLY

STATE OF INDIANA     )  
                              ) SS                   BEFORE THE HAMILTON  
                              )  
COUNTY OF HAMILTON )                   DRAINAGE BOARD

IN THE MATTER OF MASTHEAD DRAIN

Notice is hereby given that the Hamilton County Drainage Board at its regular meeting April 27, 1998 adopted the reconstruction report of the Surveyor and the Amended Schedule of damages and assessments including annual assessment for periodic maintenance, finding that the costs, damages and expense of the proposed improvement would be less than the benefits which will result to the owner of lands benefited thereby.

The Board issued an order declaring the proposed improvement established. Such findings and order were marked filed and are available for inspection in the Office of the Hamilton County Surveyor.

If judicial review of the findings and order of the Board is not requested pursuant to Article VIII of the 1965 Indiana Drainage Code as amended within twenty (20) days from the date of publication of this notice, the findings and order shall become conclusive.

HAMILTON COUNTY DRAINAGE BOARD

BY Sharon R. Clark  
PRESIDENT

Attest:   
ADMINISTRATIVE SECRETARY

**PSFS**

(OCT) 7, 1985

1234 MARKET STREET • PHILADELPHIA, PA 19107

Commercial Banking Department

October 3, 1985

Irrevocable Letter of Credit No. 2781695685-00133  
Expiration Date: October 3, 1988

The Hamilton County Commissioners  
Hamilton County, Indiana

Gentlemen:

For the account of The Shorewood Corporation, we hereby authorize you to draw on us at sight to the extent of **\*\*U.S.\$5,000.00\*\***.

Each of your drafts must:

1. Be marked "Drawn under PSFS Letter of Credit No. 2781695685-00133 dated October 3, 1985."
2. Be presented, together with this original Letter of Credit, at our offices at 1234 Market Street, 9th Floor, Philadelphia, Pennsylvania 19107, no later than 3:00 p.m. Philadelphia time on October 3, 1988.
3. Be accompanied by the following:

Certification by The Hamilton County Commissioners of non-compliance with specifications required for Streets, Curbs, and Storm Sewers in Section 7 of the Masthead subdivision by The Shorewood Corporation. Such certification may not antedate this Letter of Credit and;

Certification by The Hamilton County Commissioners that funds drawn under this Letter of Credit will be used to bring the Streets, Curbs, and Storm Sewers into compliance in accordance with the specifications referenced.

4. Not exceed, in the cumulative aggregate, \$5,000.00

riser locations are typical only, exact placement of risers to be determined in field to follow natural slope as much as possible

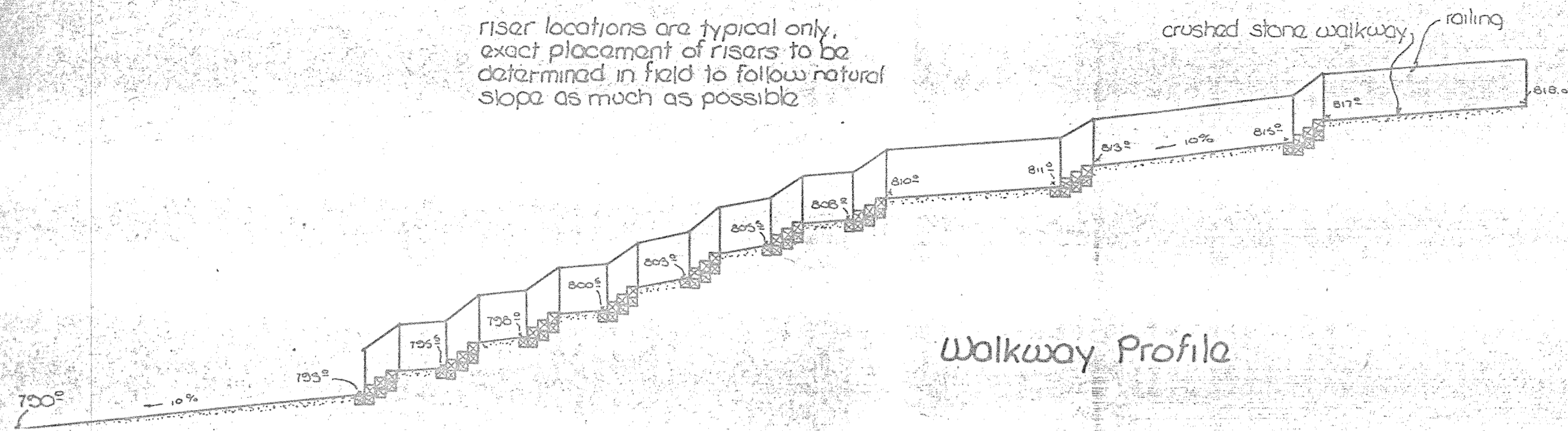

Walkway Profile

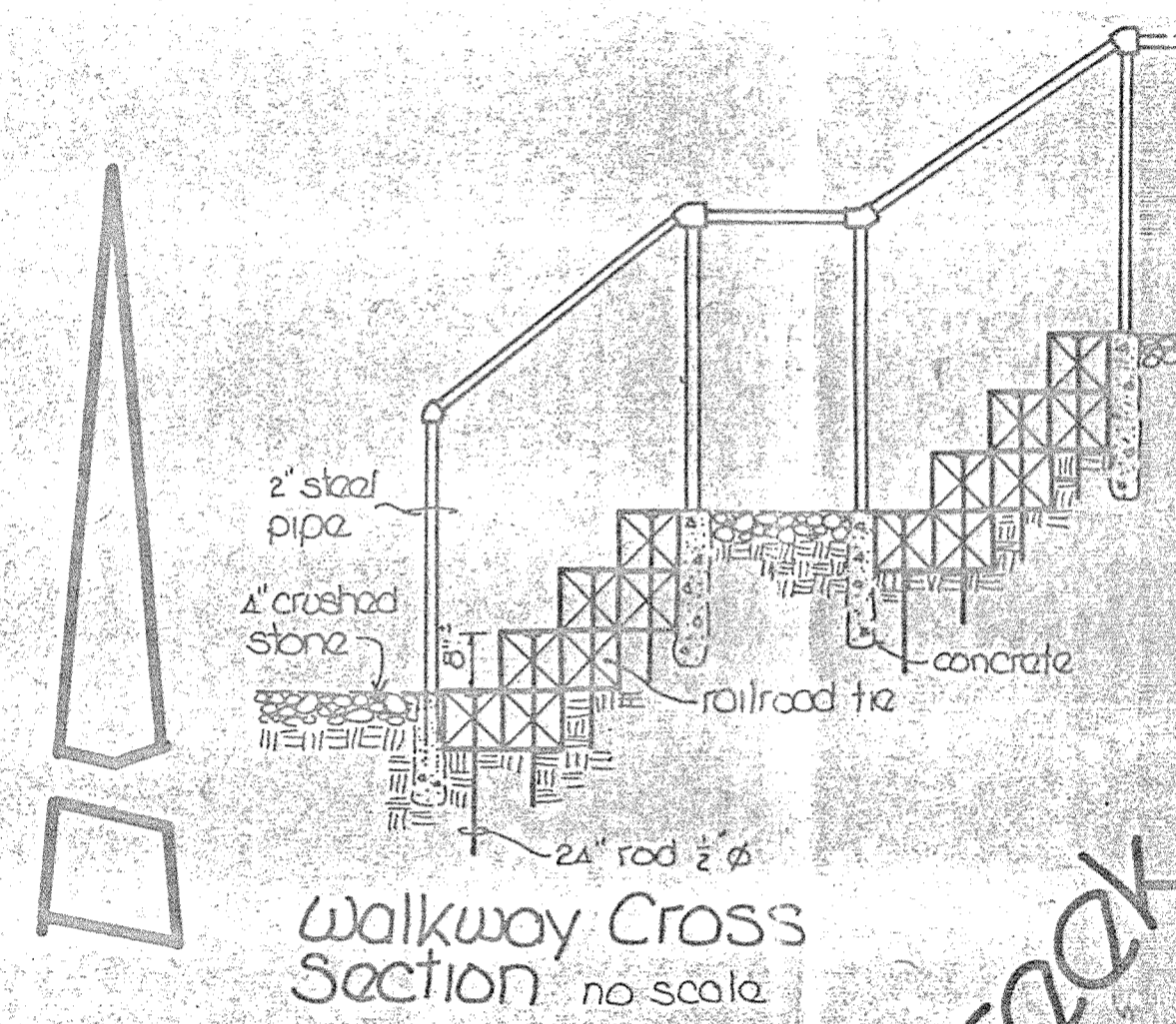

Walkway Cross Section no scale

# Legend

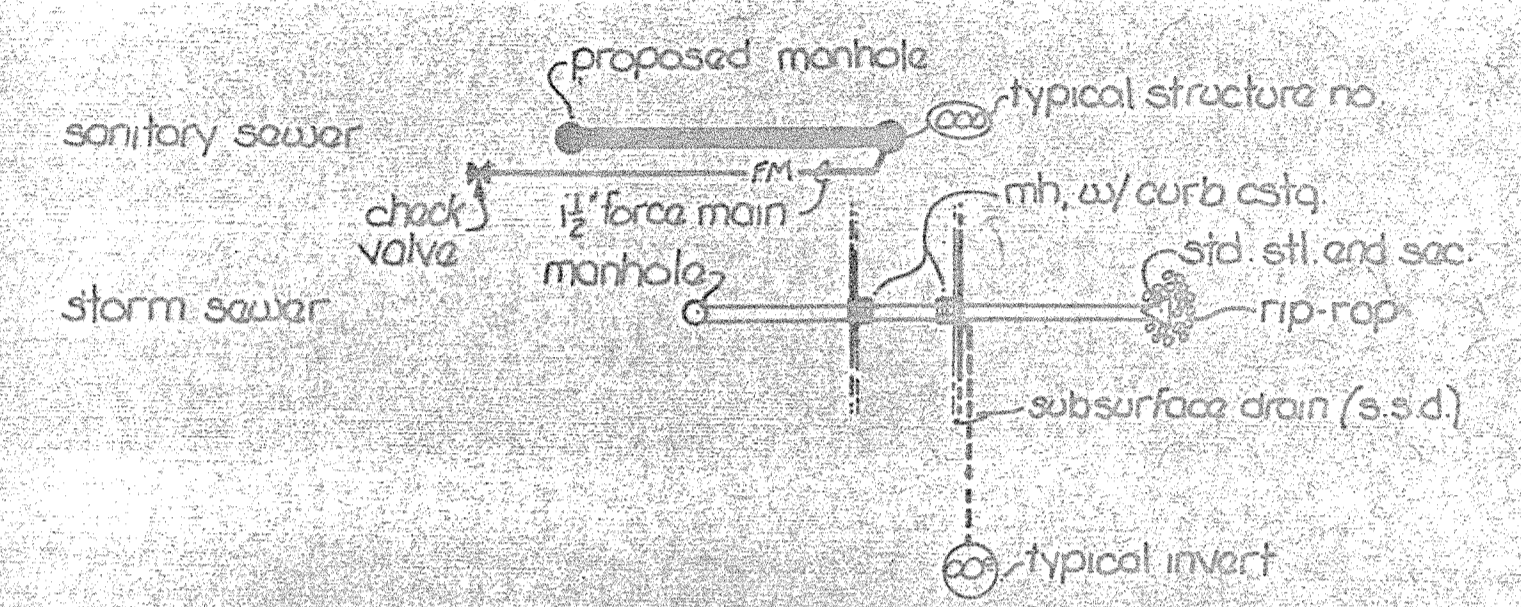

bearings, dimensions, & easements are shown for reference only, and do not necessarily depict actual recorded information, see recorded plat for exact information.

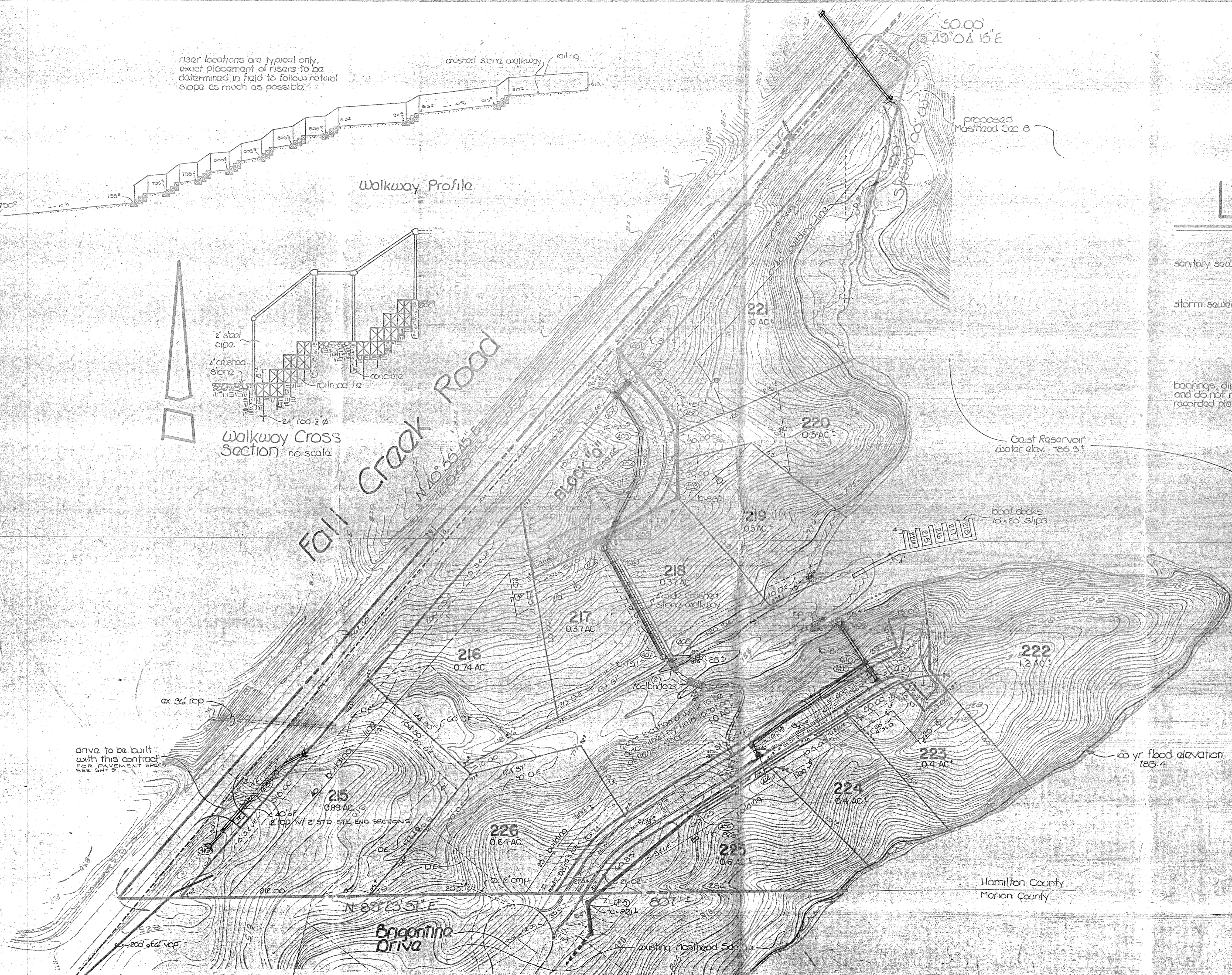

This information was gathered for input by the client and is not to be used for any other purpose without the consent of the client.

Draw Date: 2-2-01

Entered by: JOH

**FILED**  
MAR 12 1997  
OFFICE OF HAMILTON COUNTY SURVEYOR

CERTIFIED BY	REVISIONS	<b>PAUL I. CRIFE, INC.</b> 7172 GRAHAM ROAD INDIANAPOLIS, INDIANA 46250 (317) 842-6777	TECH. CHK.	DRAWN BY	SCALE	DATE	CLIENT	DWG. TYPE	FILE NUMBER
	DATE		Rev. 10/1/82 SAN.SWR. _____ _____	JAS	DKS	1"=50'	2-10-82	Mosthead Sec. 7	
			DFTNG. CHK.	DRAWING TITLE				JOB NUMBER	
			UWGX	Site Development Plan				791100110007	